

# SB45 WB-G: 2 POST WASH BAY HOIST

## Installation/Operation & Maintenance Manual

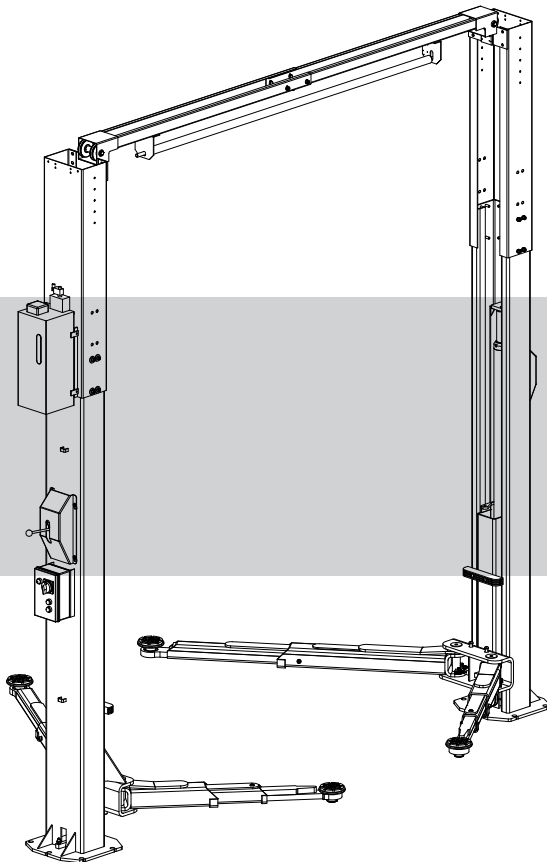

**SB45 WB-G**



Please read this manual before you get started.

You must read and understand the precautions for safety purposes and any damages that may occur to your property.

Updated 05/06/2019

## NOTE TO THE USER

**Thank you for purchasing the SB45 WB-G Wash Bay Hoist**  
**Please read this instruction carefully for safety and proper use of the car hoist, and retain it for future reference.**

- This Manual is for model: SB45 WB-G  
Design Registration V1803328  
Vehicle Hoist - Model No. SB45 WB-G Max Rated Capacity 4500kg
- As for the assurance of safety in design and construction of car hoist, read this Manual first.
- Please make sure that this Manual is delivered to end users for their implementation of safety.
- Don't use the car hoist in a potentially explosive atmosphere.

ANY PART OF THIS PRINT MUST NOT BE REPRODUCED IN ANY FORM  
WITHOUT PERMISSION.  
THIS PRINT IS SUBJECT TO CHANGE WITHOUT NOTICE.

This manual was prepared in December of 2018. The Specifications/images are subject to change without prior notice, images and sketches are for illustration purposes only.

# TABLE OF CONTENTS

|                                     |    |
|-------------------------------------|----|
| <b>Introduction</b>                 | 4  |
| Features and Characteristics        | 4  |
| Part Descriptions                   | 6  |
| Description                         | 7  |
| Specification                       | 7  |
| <b>Safety</b>                       | 8  |
| Danger/Warning/Caution              | 8  |
| <b>Installation Procedures</b>      | 10 |
| Checklist Before Installing         | 10 |
| Place of Installation–Layout        | 11 |
| <b>Operation</b>                    | 16 |
| Check Points Before Operation       | 16 |
| Operation                           | 17 |
| Operation Procedures of Each Part   | 28 |
| <b>Maintenance</b>                  | 20 |
| Maintenance                         | 20 |
| Troubleshooting                     | 23 |
| Check List and Periodic Maintenance | 24 |
| <b>Appendix</b>                     | 24 |
| Spare Parts List                    | 24 |
| Pressure Valve Adjustment           | 31 |

## Features and Characteristics

### Introduction

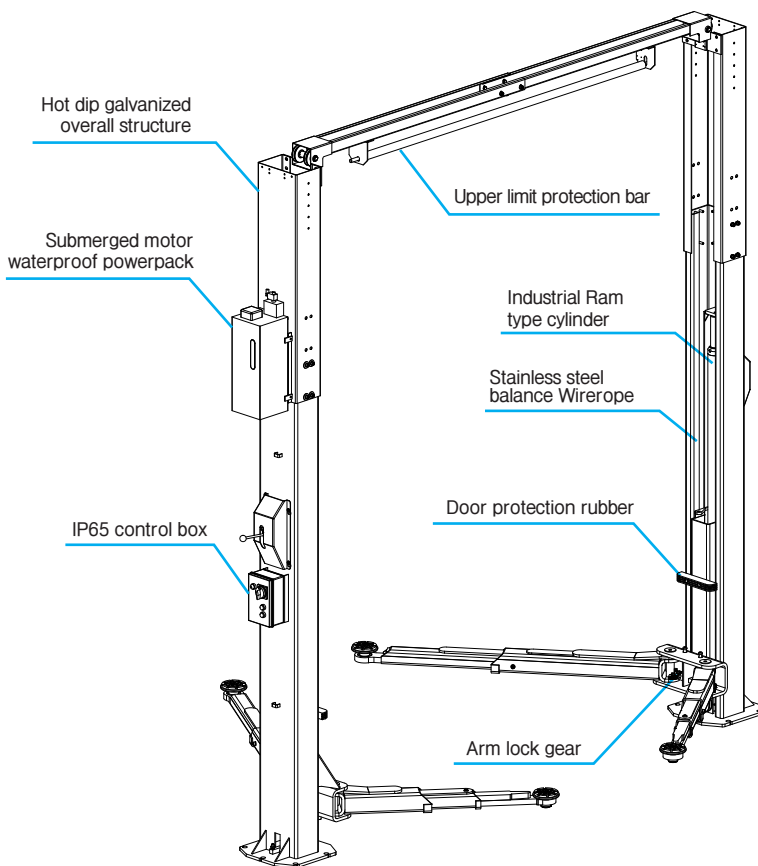

#### ■ Upper limit protection bar

► A limit bar prevents the vehicle from being lifted too high. This feature effectively protects taller vehicles from being damaged.

Cable adjustment

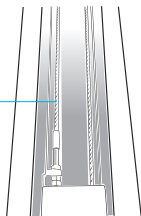

#### ■ Cable adjustment

► Correct adjustment ensures synchronization of both carriages.

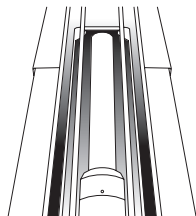

#### ■ Operation of ram type cylinder

Two individual cylinders ensure reliability and longevity.

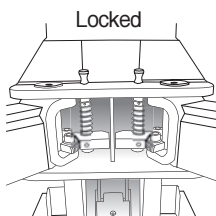
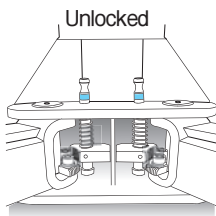

#### ■ Powerful arm lock gear

► At the bottom position the gears are unlocked to allow arm adjustment. When the hoist is raised the gears are automatically locked ensuring complete safety.



#### ■ Door protection rubber

► Vehicle door protect during working.



#### ■ Safety locker

► Safety locker system.

## Part Descriptions

### Introduction

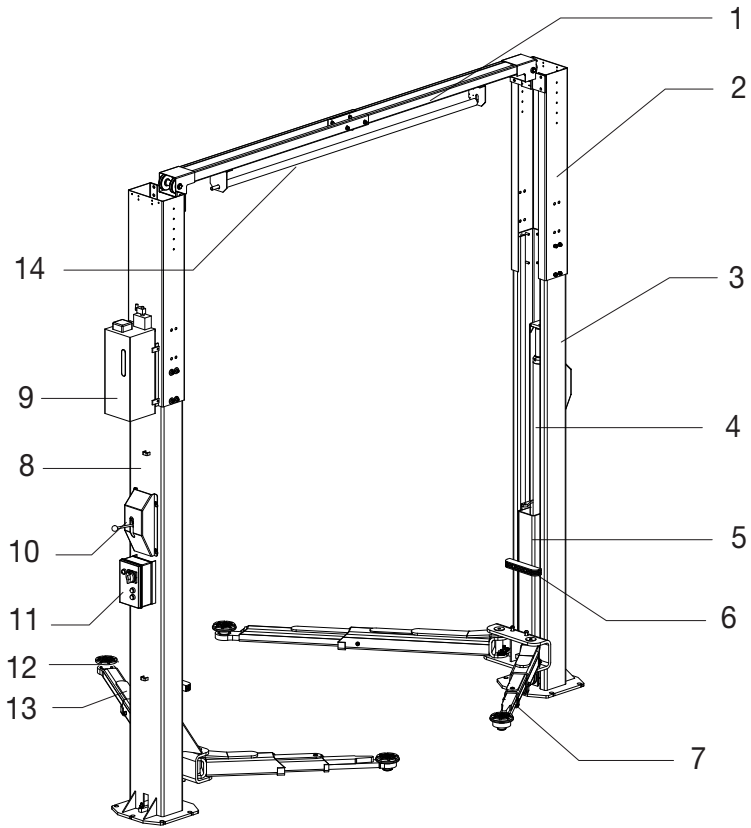

|   |                            |    |                               |
|---|----------------------------|----|-------------------------------|
| 1 | Cross beam                 | 9  | Power Pack                    |
| 2 | Post extension             | 10 | Locker cover & Locker(inside) |
| 3 | Slave post                 | 11 | Control box                   |
| 4 | Cylinder                   | 12 | Pick-up pad                   |
| 5 | Carriage                   | 13 | Short arm                     |
| 6 | Door protection rubber pad | 14 | Top limit touch bar           |
| 7 | Short arm                  |    |                               |
| 8 | Drive post                 |    |                               |

## Description

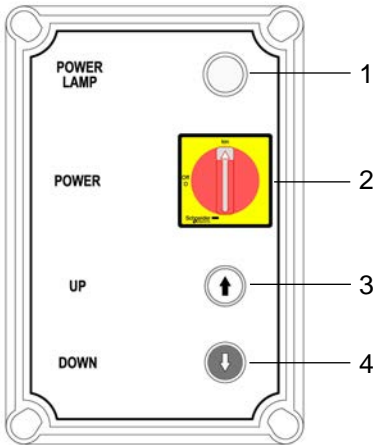

### ■ Functions (Control panel)

1. Power lamp
  2. Main switch
  3. Lifting button
  4. Lowering button
- 1) To park vehicle (when lock is Not released)  
2) To lower the hoist (When lock is released)

## Introduction

## Specification

| MODEL         | SB45 WB-G                  |
|---------------|----------------------------|
| CAPACITY      | 4500 Kg                    |
| MAX. PRESSURE | 18 Mpa                     |
| MAX.HEIGHT    | 1,895~1,940 mm             |
| MIN. HEIGHT   | 95~140 mm                  |
| STROKE        | 1750 mm                    |
| LIFTING TIME  | Approx. 45 ~ 60 sec        |
| LOWERING TIME | Approx . 35 ~ 50 sec.      |
| POWER & MOTOR | 3Ph 2.2Kw 4Poles 415V 50Hz |
| NET WEIGHT    | About 730 kg               |

## Danger/Warning/Caution

### Rules for illustrations in the manual

These are the rules for the illustrations in the manual. Make sure that you read and understand them. The rules are applied only to the manuals of Molnar Hoists



|  |                                                                                       |
|--|---------------------------------------------------------------------------------------|
|  | Make sure you follow the instructions, otherwise critical injuries can occur.         |
|  | Make sure you follow the instructions, otherwise critical injury or damage can occur. |
|  | Make sure you follow the instructions, otherwise injury or damage can occur.          |
|  | The terms are described to enhance the understanding of the equipment.                |
|  | Information to use the equipment efficiently.                                         |
|  | Precautions or check points for the use of the equipment.                             |
|  | Please refer to the page                                                              |



Do not come under the vehicle during operation.

► It may cause severe injuries.



Evacuate to a safe place instantly in the event that the vehicle tips.

► It may cause severe injuries.



Do not overload the rated capacity.

► It may cause severe injuries.

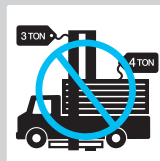

※ Not following the instructions can lead to a critical accident involving your life. Make sure you follow the instructions.



### Warning before using the equipment

Only trained personnel may operate the equipment. Inexperience can cause accidents.



Position the vehicle to make sure that it is balanced front and rear, right and left (otherwise the vehicle may fall off).

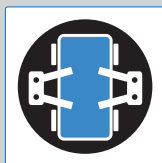

Do not operate damaged equipment (a critical accident could occur – contact your Heshbon supplier)



After that a vehicle is placed on the hoist make sure that the hand brake is applied. Passenger transport is forbidden.







### Warning when operating

Allow no unauthorized persons in the work area.



Before lowering the hoist, check that there are no obstructions under the vehicle or the hoist arms.



When the vehicle is lifted, do not rock it as this may dislodge it.



Do not raise a vehicle using one pair of arms only.



### Warning when operating

To avoid injury, keep your feet clear of the arms and carriages.



Before going under the hoist, make sure that the safety pawls are engaged.



To avoid being electrocuted, disconnect the main power before opening the control panel.



Do not modify the control panel or the safety functions as this may impair their function.

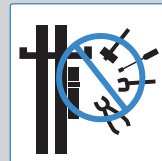

### Warning when operating

Do not rock the vehicle when lifted. Do not use a high pressure cleaner as the vehicle lower part.



Read and fully understand the manual before using the hoist.

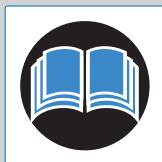

### Warning before using the equipment

Check the safety devices to see that they are clean and operable.

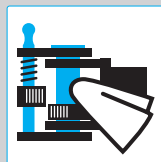

If the hoist is idle for a long time, disconnect the main power supply. In the event of thunder storm, disconnect the main power supply.

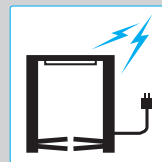

## Check List Before Installing

### Installation site

| Concrete Floor requirements                                       | Anchor Bolts                  |
|-------------------------------------------------------------------|-------------------------------|
| Recommended floor thickness<br>125mm thick, 25MPA grade, F82 mesh | Thru-Bolt<br>20mm D X 160mm L |
| Minimum floor thickness<br>100mm thick, 25MPA grade, F72 mesh     | STA bolts<br>20mm D X 110mm L |

### Installation site

Vehicle access to the hoist must be safe and easy.

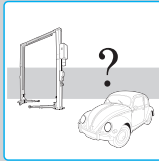

There must be a safe working distance of minimum 1m between the hoist and the wall or any fixed object.

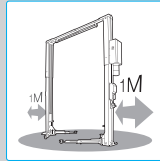

To ensure that the anchor is secure, the hole for an anchor bolt must be more than 2/3 of the bolt length.

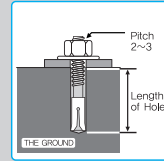

It is recommended that Molnar endorsed technician's shall install the hoist, otherwise a failure may occur.

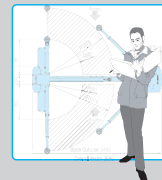

The hoist must be installed by competent technicians. Failure to observe this makes the hoist warranty invalid. If the hoist is to be moved to another site at a later date, it must be reinstalled by competent technicians.

## Place of Installation–Layout

Check points before selecting the place of installation.

- ① Distance from wall or any fixed object
- ② Drive-on direction
- ③ Positions of power post and slave post
- ④ Ceiling height and height of cross member

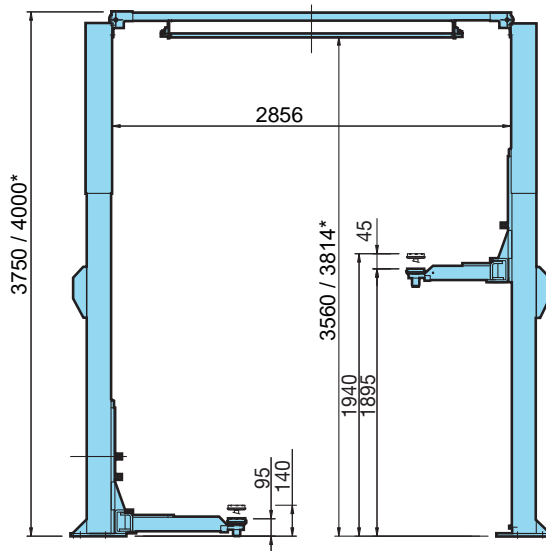

\*Depending on version

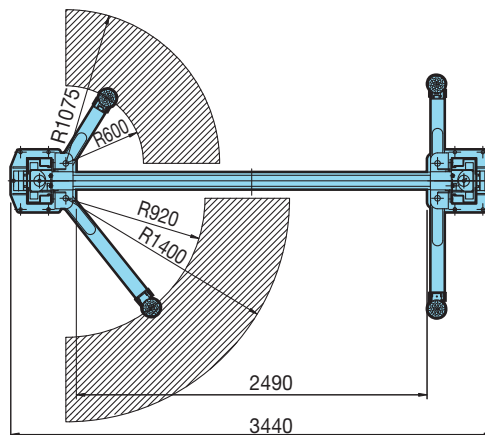

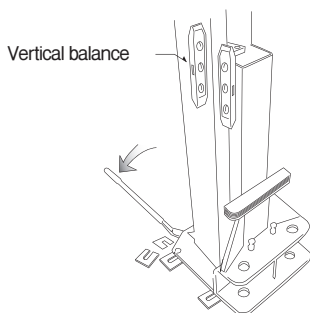

## ■ Setting up a post

► Before securing with anchor bolts, ensure that the post is vertical in both directions.

### 1 Adjusting verticality

Check that the post is vertical in both directions and adjust by means of the shim plates provided.

### 2 Fixing the post

Fix by anchor bolts.

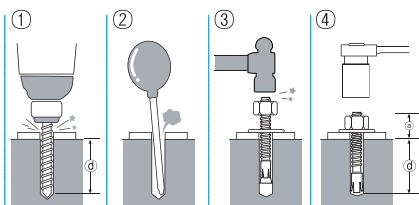

## Anchor bolt installation

- ① Drill a hole
- ② Clean the inside of the hole
- ③ Put an anchor bolt into the hole and hammer it until it reaches the bottom of the hole
- ④ Tighten the bolt with a spanner (a: 35~45mm)  
(Tighten more 80N.m~100N.m)

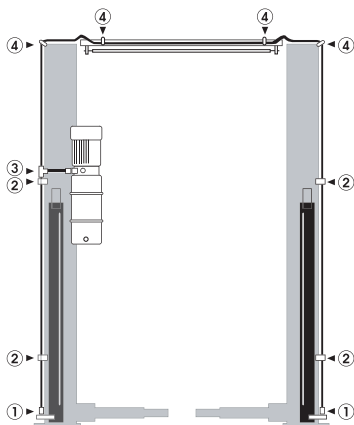

## ■ Connection of the hydraulic hose

► Before setting up the post, connect the hydraulic hose and tighten it with a 19/17mm spanner. Check for oil leakage.

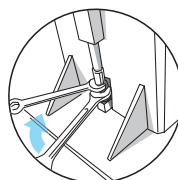

## ■ Cable synchronization

► The cables ensure synchronization between the carriage on the power post and the carriage on the slave post.

- ① Top roller for cable.
- ② Synchronization cable from the opposite carriage.
- ③ Synchronization cable mounting bracket.
- ④ Bottom roller for cable.

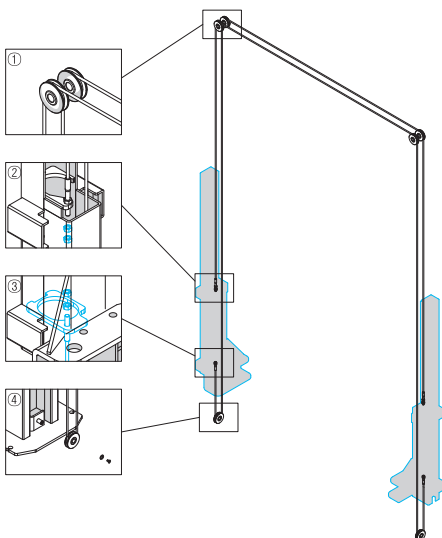

## Adjusting the cables

Check which carriage first touches the base plate of the post when the hoist descends and then tighten. This cable until both carriages rest on the base plates simultaneously.

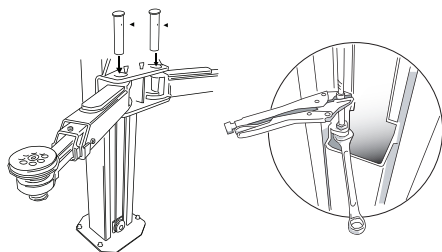

## How to check the tuning adjustment.

- ① Check with "naked eyes" that the bottom post reached simultaneously see above.
- ② Check with ears  
Check the sound of the parking pawls engaging in each slat during ascent. The "clicks" should be simultaneously if not tighten the cable on the later pawl. (The wire of the locker that sounds later shall be tightened more tensely.)

## Hydraulic Diagram

### Installation

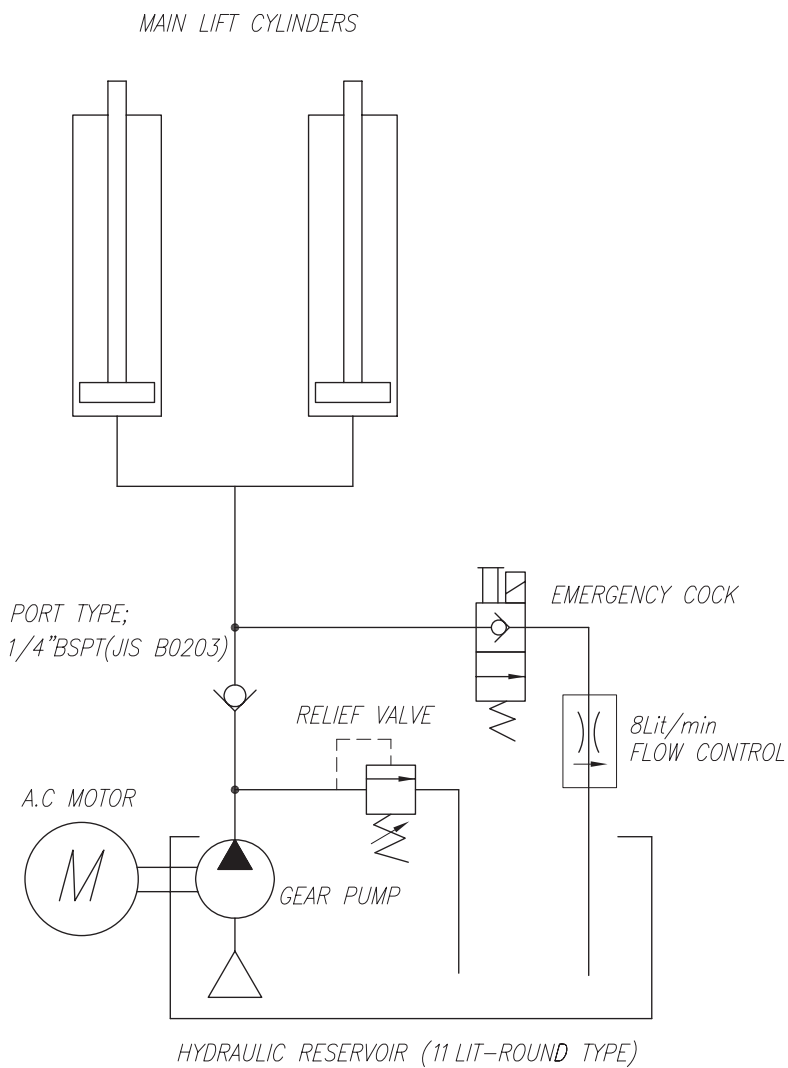



## Check Points Before Operation

Before loading the hoist check the following points.

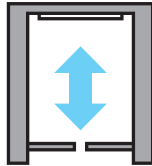

### ■ Test Operation

► Operate the hoist up and down 2-3 times to check the full travel of the carriages.



### ■ Switch Operation

► Check that the ascent and descent lever operate correctly.

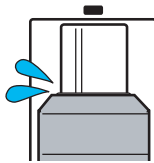

### ■ Hydraulic Check

► Check that there are no hydraulic leaks from either cylinders, pipes, or hose joints.



### ■ Mechanical Check

► Check the tightness of all nuts, bolts, etc.

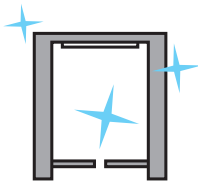

### ■ Exterior Check

► Check the exterior of the hoist to ensure that there is no obvious damage.

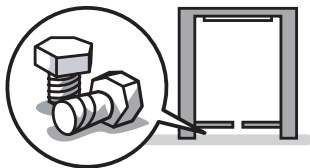

### ■ Cleanliness

► Check every day that the hoist and the work area are clean and free from debris or obstructions.



## Operation

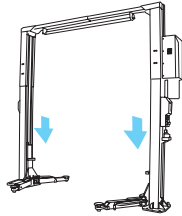

### 1 Prior to use

Check that the carriages and arms are at lowest position by operating the descent push button.

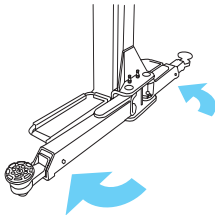

### 2 Prior to vehicle entry

At the bottom position the arm locks are released. Swing the arms to the straight-ahead position as shown.

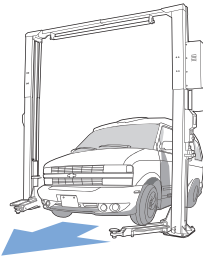

### 3 Vehicle entry

Position the vehicle centrally between posts with the vehicle's center of gravity in line with the 2 posts.

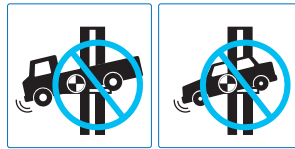

### 4 Arm and pad adjustment

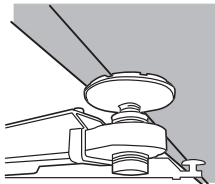

Swing in the 4 arms under the vehicle and adjust the length of each arm so that the pick-up pad is directly underneath the pick-point recommended by the vehicle manufacturer. Each pad is fitted with telescopic thread allowing a 2-stage adjustment. Adjust the height of each pad to engage the pick-up point.

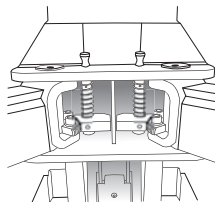

### 5 Check the arm locks

Raise the hoist approx. 50mm and check visually and mechanically to ensure that each arm lock is firmly engaged.

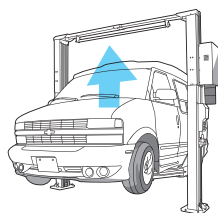

## 6 Ascent

After checking that the 4 pads are correctly adjusted under the pick-up points recommended by the vehicle manufacturer and that the arm locks are engaged as previously described, press the ascent push button and raise the hoist to the required working height.



## 7 Vehicle repairs

Before going under the hoist, check again visually the pick-up pads and arm locks. After repair of the vehicle, check the floor and work area to ensure that there are no obstructions. Press the descent push button to lower the hoist. When the hoist is at the bottom position, the arm locks are released automatically. Release the pick-up pads from the pick-up points by screwing down the telescopic threads. Swing the arms from under the vehicle to the straight-ahead position and remove the vehicle.

## Operation Procedures of Each Part

### Operation

#### ■ Arm Lock Operation

### 1 Ascent

When the carriages go up the arm locks are engaged automatically. Ensure that the gears controlling the locks are in mesh, i.e. fully engaged. If not, the arm must be marginally adjusted until the spring loading operates and locks successfully.

### 2 Descent

At the bottom position the locks are automatically disengaged.

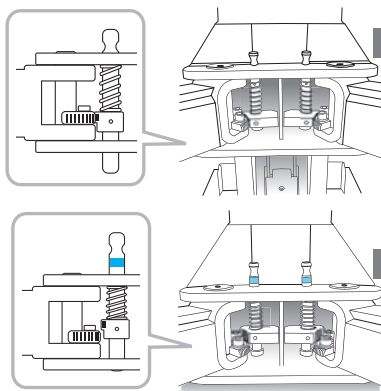

#### ■ Arm Operation

### 1 Adjustment of arm length

the arms are telescopic with either 2 sections or 3 sections as shown to allow the required adjustment.

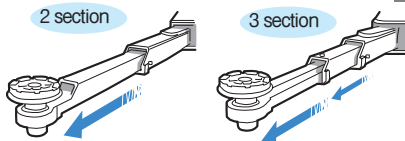

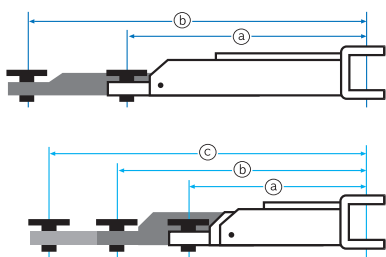

## ► 26K Arm

### 2-section telescopic arm

- a 920 mm
- b 1400 mm

### 3-section telescopic arm

- a 600 mm
- b 850 mm
- c 1075 mm

## 2 3-stage telescopic pad adjustment

The height of the pad can be adjusted 3 stages as shown below.

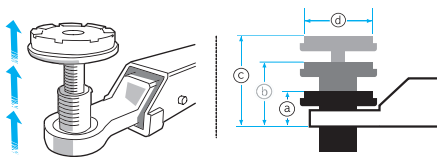

- a 55 mm
- b 75 mm
- c 100 mm
- d Dia.120mm

Operation

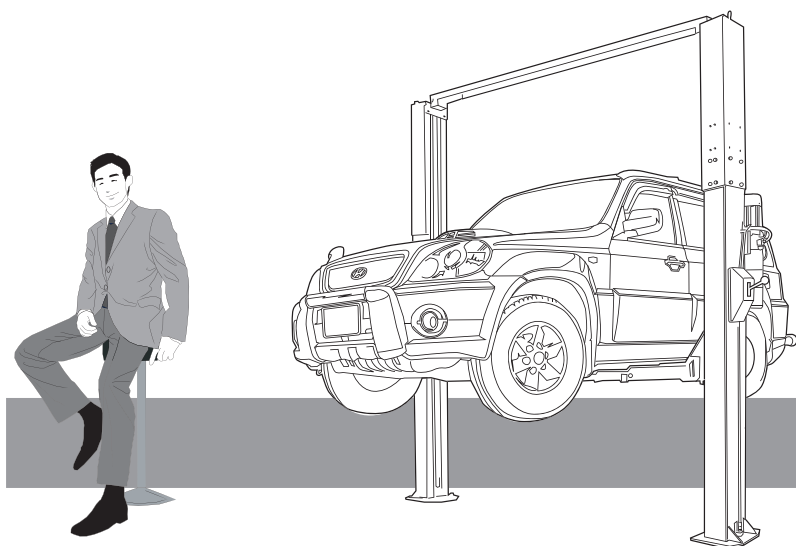

## Maintenance

### ■ Lubrication

► At 2 or 3 month intervals, depending on service usage.

#### 1 Molybdenum disulphide grease

► Apply molybdenum disulphide grease liberally to the carriage guides and the guide runners inside the posts.

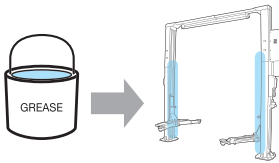

#### 2 Lubricating oil

► Lubricate with oil the upper and lower cable rollers and axles.

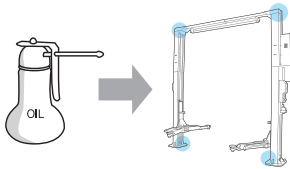

### ■ Cleanliness

► Check every day that the hoist is clean and that the work area is clean and free from debris or obstructions.

► Clean safety devices at 2-or-3-month intervals, depending on service usage.  
– Clean the arm lock gears and surroundings, lubricate the gear teeth and the release mechanisms. Clean the safety lock pawls, and lubricate the axles.

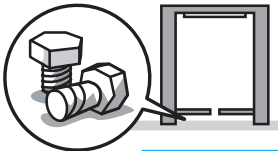

### ■ Synchronization Cable Adjustment

► Check that both carriages are fully parked on the base of the hoist at the bottom position. Raise the hoist without load and listen to the audible clicks of the 2 lock pawls. The synchronization of the 2 carriages is correct when both lock pawls click simultaneously. Adjust the length of the 2 cables as shown to fulfill this.

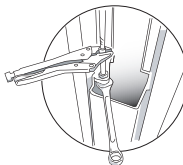

## ■ Arms

► Once a year check the condition of each arm by sliding each section to its fully extended position and ensure that the arm stop is working correctly.

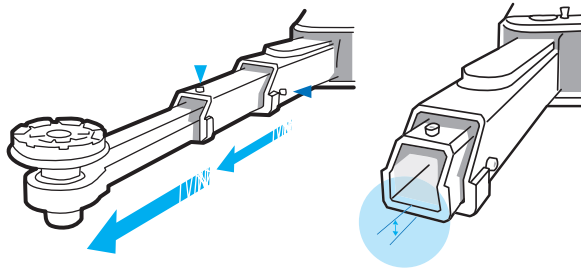

## ■ Emergency lowering in the event of power failure

In the event of a power failure the hoist must be lowered manually. Raise each carriage by approx. 30mm using a trolley jack and a suitable extension to this and manually release the lock pawls. Fix the lock pawls mechanically so that spring pressure does not re-engage them. Remove the trolley jack and extension. Repeat this operation on the opposite carriage. Remove the trolley jack and extension. As a safety precaution before opening the power pack, switch off the mains and switch off the lockable main switch on the control panel.

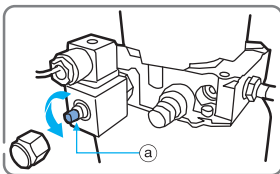

- Remove the cover from the power pack.
- Remove the hexagon cap from the solenoid valve as shown.
- Turn the emergency cock lever slowly and carefully anti-clockwise to ensure that the hoist lowers slowly and safely.

## Steps after completing the operation

- ① Turn the lever clockwise and lock it securely.
- ② Refit the hexagon cap.

## 2 Power pack pressure



The power pack pressure is set by the factory in accordance with the lift's maximum rated capacity. The pressure regulator is sealed by the factory and should not be tampered with. Excessive adjustment can result in serious damage. If the hoist fails to raise the maximum rated load, contact your Molnar approved maintenance engineer.

Standard pressure settings model

SB45 WB-G

18 Mpa

## 3 Oil change

Oil should be changed 2 months after installation and thereafter annually.

### Oil change procedure

- Remove the cover of the hydraulic unit.
- Remove the oil filter cap and dipstick. Carefully remove the oil drain plug and allow the oil to discharge into a suitable container.
- Refit the drain plug and tighten
- Refill the oil tank with new oil
- Check with the dipstick that the level is correct; raise and lower the hoist and recheck that the level is still correct. If not, top up with oil.
- Refit the cover

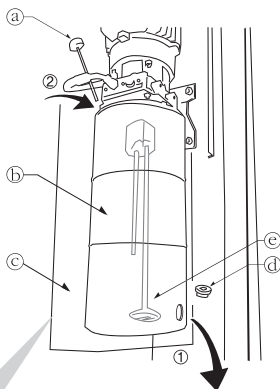

a Filter cap and dipstick  
b Oil tank  
c Drain plug  
d Pump filter

1 Oil filter  
2 Oil discharge



At the annual oil change, after having drained the oil tank, remove the oil tank from the pump and check the condition of the pump filter. Clean or replace as necessary. Replace tank and follow the above procedure.

## Troubleshooting

|                                     | Symptoms                                                                                    | Check point                                                                                                                                                                                                                                                                                  | Corrective Action to be taken                                                                                                                                                                                                                                                                    |
|-------------------------------------|---------------------------------------------------------------------------------------------|----------------------------------------------------------------------------------------------------------------------------------------------------------------------------------------------------------------------------------------------------------------------------------------------|--------------------------------------------------------------------------------------------------------------------------------------------------------------------------------------------------------------------------------------------------------------------------------------------------|
| Wire cable and Locking device       | Carriages and arms do not synchronize during lifting.                                       | 1. Check if wire rope is partially loosened.<br>2. Check if clip of wire rope is loosened.                                                                                                                                                                                                   | 1. Readjust the fixing bolts of the wire rope to ensure that the carriages are leveled.<br>2. Tighten clips after adjustment.                                                                                                                                                                    |
|                                     | Lift does not lower when down lever is operated or if down button is operated independently | 1. Check if the safety lock is engaged in the carriage and under load.<br>2. Check the electrical power is available at the down button and solenoid valve.                                                                                                                                  | 1. Raise the lift, disengage the safety lock with the down lever, and lower the lift.<br>2. Repair the electrical connections if possible, alternatively lower the lift in accordance with the manual descent procedure.                                                                         |
|                                     | Carriages and arms do not synchronize during lowering.                                      | 1. Check if the oil at load head cover is sufficient.<br>2. Check if the air is mixed at the hydraulic oil.                                                                                                                                                                                  | 1. Top up the oil tank to the correct level.<br>2. Bleed the air from the hydraulic unit                                                                                                                                                                                                         |
|                                     | Safety lock does not operate during lifting or lowering.                                    | 1. Check the connection of wire and connector.<br>2. Check the operation of manual lever.                                                                                                                                                                                                    | 1. Reconnect if necessary.<br>2. Release manual lever.                                                                                                                                                                                                                                           |
| Hydraulic system and its components | Abnormal noise from the motor.                                                              | 1. Rated capacity is exceeded.<br>2. Relief pressure is low.<br>3. Shortage of hydraulic oil.                                                                                                                                                                                                | 1. Operate within rated capacity.<br>2. Adjust to 4 ton.<br>3. Bleed the hydraulic unit after topping up the oil level.                                                                                                                                                                          |
|                                     | Hydraulic oil leakage                                                                       | 1. Defective hydraulic hoses<br>2. Leakage from hydraulic unions<br>3. Lead age from cylinder high pressure seal                                                                                                                                                                             | 1. Replace the hydraulic hose.<br>2. Tighten the union connection<br>3. Request A/S center.                                                                                                                                                                                                      |
|                                     | Oil connections                                                                             | Hydraulic fluid pollution by water or foreign debris.                                                                                                                                                                                                                                        | 1. Exchange oil (annually)<br>(Hydraulic oil : 32CST/11liter)<br>First oil change 2 months after installation. Therefore regular oil changes at annual intervals.                                                                                                                                |
|                                     | The lift does not rise.                                                                     | 1. Check for oil leaks or damage to the hydraulic unit.<br>2. Check that the correct operating procedure is being used.<br>3. Check that the load is not above the rated capacity.<br>4. Check that the pressure valve is correctly adjusted.                                                | 1. Request A/S center.<br>2. Bleed the hydraulic system.<br>3. Limit the load to the rated capacity or less.<br>4. Adjust to 4ton.                                                                                                                                                               |
|                                     | The lift does not lower.                                                                    | 1. Check if the safety lock is engaged and under load.<br>2. Check if the electric circuit is damaged.                                                                                                                                                                                       | 1. Re-lower after lifting slightly to allow the safety lock to disengage.<br>2. Refer to electric check points.                                                                                                                                                                                  |
|                                     |                                                                                             | Lower it in accordance with the procedure to lower manually the lift during emergency, and then, request A/S center.                                                                                                                                                                         |                                                                                                                                                                                                                                                                                                  |
| Electric components                 | Motor does not operate and/or abnormal noise from the motor.                                | 1. Check if the motor is damaged.<br>2. Check for blown fuses.<br>3. Check if the push button is damaged.<br>4. Check if the upper limit is operative.<br>5. Check that the wire gauge on the electrical supply is correct.<br>6. Check that the input voltage is no less than minimum 200V. | 1. Replace the motor (Request A/S center).<br>2. Replace the fuse after solving trouble.<br>3. Replace the push button (Request A/S center).<br>4. Re-operate after lowering the lift.<br>5. Replace to the cable with over 3,5mm <sup>2</sup> diameter.<br>6. Increase the input power capacity |
|                                     | NFB or circuit breaker (30A) is operated.                                                   | 1. Check the Contact of magnetic contactor.<br>2. Check the capacity of circuit breaker.<br>3. Check if the wire is damaged.                                                                                                                                                                 | 1. Replacement (Request A/S center).<br>2. Replacement (Request A/S center).<br>3. Replacement after checking.                                                                                                                                                                                   |
|                                     | Motor operates but lift does not rise.                                                      | 1. Check that the phases are correctly connected that the motor rotates anti-clockwise.<br>2. Check if hydraulic lines is damaged                                                                                                                                                            | 1. Re-operate after changing the phase connection.<br>2. Refer to check points for hydraulic cylinder and unit.                                                                                                                                                                                  |

## Check list and periodic maintenance

| Inspection period | Points to be checked            | Items to be checked                        | Inspection method    | Action to be taken       | Replacement period |
|-------------------|---------------------------------|--------------------------------------------|----------------------|--------------------------|--------------------|
| 1 week            | Rubber Support for adjustment   | Abrasion and deformation                   | Visual               | Replacement if necessary | 1 year             |
|                   | Magnetic                        | Damage of contact points                   | Measurement          | Replacement              | 2 year             |
| 3 months          | Wire Rope                       | Abrasion, deformation and Breaking of wire | Visual               | Replacement              | 2 year             |
|                   | Leaf Chain                      | Abrasion and deformation                   | Visual               | Replacement              | 4 year             |
|                   | Leaf Chain Wheel and DU bearing | Abrasion                                   | Visual               | Replacement              | 4 year             |
|                   | Axle for Arm Lock               | Operation of lock                          | Visual               | Replacement              | 4 year             |
|                   | Housing for Arm Lock            | Operation of lock                          | Visual               | Replacement              | 4 year             |
|                   | Dust-proof rubber               | Abrasion and deformation                   | Visual               | Replacement              | 2 year             |
| 6 months          | Carriage Guide                  | Abrasion                                   | Visual / Measurement | Replacement              | 3 year             |
|                   | Electrical components           | Damage to components                       | Visual               | Replacement              | 3 year             |
|                   | Hydraulic Oil Level             | Shortage of oil                            | Visual               | Replacement              | 1 year             |
| 1 year            | Piston Seal Kit                 | Oil leak or deformation                    | Visual               | Replacement              | 3 year             |
|                   | Load Seal Kit                   | Oil leak or deformation                    | Visual               | Replacement              | 3 year             |



---

# **APPENDIX**

## **PART LIST**

### **MODEL**

---

**SB45 WB-G**

---

---

This manual was prepared in December of 2018. The Specifications/images are subject to change without prior notice, images and sketches are for illustration purposes only.

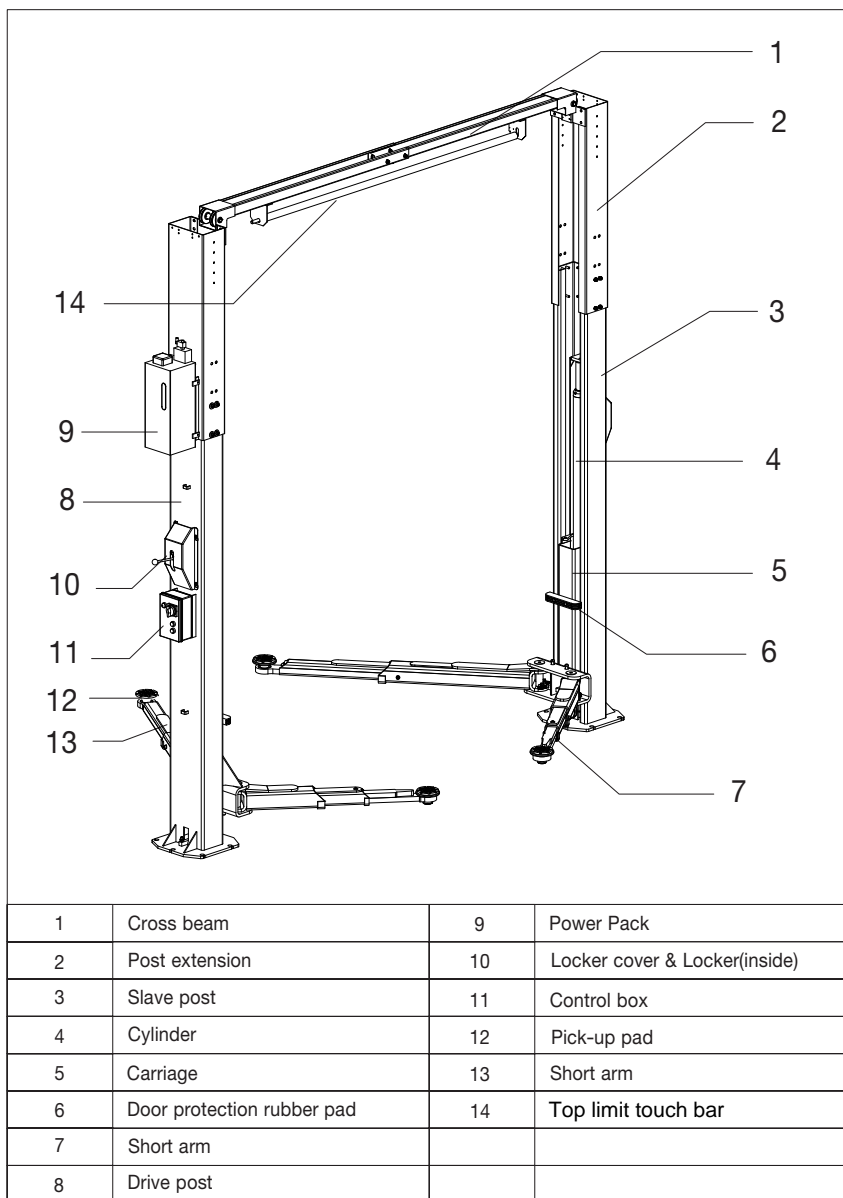

| Item | Description              | Part Number |
|------|--------------------------|-------------|
| 1    | Post                     | SB45-MP-1   |
| 2    | Extended Post            | SB45-MP-2   |
| 3    | Lock Cover               | SB45-MP-3   |
| 4    | Lock Shaft               | SB45-MP-4   |
| 5    | Lock Spring 1            | SB45-MP-5   |
| 6    | Lever Handle             | SB45-MP-6   |
| 7    | Lever Shaft              | SB45-MP-7   |
| 8    | Lock Wire Fixture        | SB45-MP-8   |
| 9    | Lock Spring 2            | SB45-MP-9   |
| 10   | E-Ring                   | SB45-MP-10  |
| 11   | Lever Connector          | SB45-MP-11  |
| 12   | Wrench Bolt              | SB45-MP-12  |
| 13   | Lock Spacer              | SB45-MP-13  |
| 14   | Lock Block               | SB45-MP-14  |
| 15   | Spring Pin               | SB45-MP-15  |
| 16   | Down Limit Switch        | SB45-MP-16  |
| 17   | Lock Wire Roller         | SB45-MP-17  |
| 18   | Lock Wire Roller Bracket | SB45-MP-18  |
| 19   | Control Panel            | SB45-MP-19  |
| 20   | Pilot Lamp               | SB45-MP-20  |
| 21   | Key Switch               | SB45-MP-21  |
| 22   | Push Button Switch       | SB45-MP-22  |
| 23   | Wire Roller              | SB45-MP-23  |
| 24   | Power Unit               | SB45-MP-24  |
| 25   | Anti-Vibrated Rubber     | SB45-MP-25  |
| 26   | Up Limit Switch          | SB45-MP-26  |
| 27   | Hexa Nut                 | SB45-MP-27  |
| 28   | Flat Washer              | SB45-MP-28  |
| 29   | Hexa Bolt                | SB45-MP-29  |
| 30   | Upper Support Beam       | SB45-MP-30  |
| 31   | Power Unit Cover         | SB45-MP-31  |

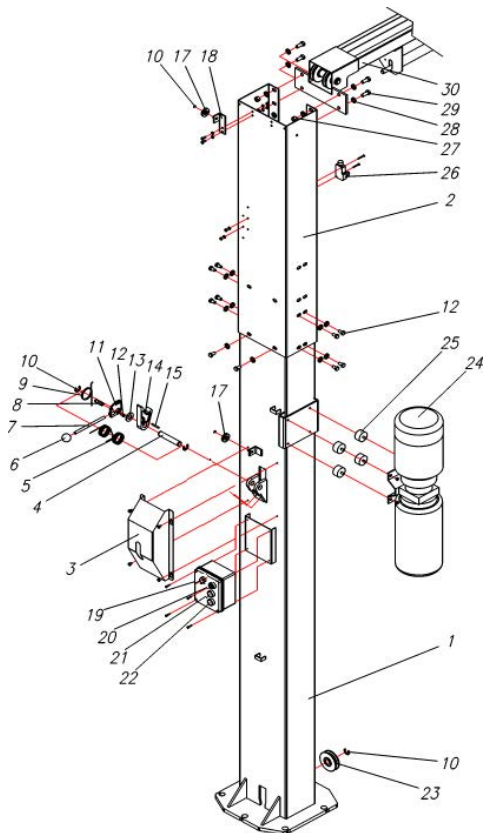

| Item | Description         | Part Number |
|------|---------------------|-------------|
| 1    | Carriage            | SB45-CC-1   |
| 2    | Carry Guide         | SB45-CC-2   |
| 3    | Arm Shaft           | SB45-CC-3   |
| 4    | Door Protect Rubber | SB45-CC-4   |
| 5    | Flat Washer (M8)    | SB45-CC-5   |
| 6    | Wrench Bolt (M8)    | SB45-CC-6   |
| 7    | Rod Bar             | SB45-CC-7   |
| 8    | Wear Ring           | SB45-CC-8   |
| 9    | Piston              | SB45-CC-9   |
| 10   | Locking Bolt (M6)   | SB45-CC-10  |
| 11   | Hose Adapter        | SB45-CC-11  |
| 12   | Cylinder            | SB45-CC-12  |
| 13   | Head Cover          | SB45-CC-13  |
| 14   | Steel Ball          | SB45-CC-14  |
| 15   | Locking Bolt (M6)   | SB45-CC-15  |
| 16   | Dust Seal           | SB45-CC-16  |
| 17   | Back Up Ring        | SB45-CC-17  |
| 18   | U-Packing           | SB45-CC-18  |
| 19   | Back Up Ring        | SB45-CC-19  |
| 20   | O-Ring              | SB45-CC-20  |
| 21   | D.U Bearing         | SB45-CC-21  |
| 22   | Wrench Bolt (M10)   | SB45-CC-22  |
| 23   | Spring              | SB45-CC-23  |
| 24   | Flat Washer (M10)   | SB45-CC-24  |

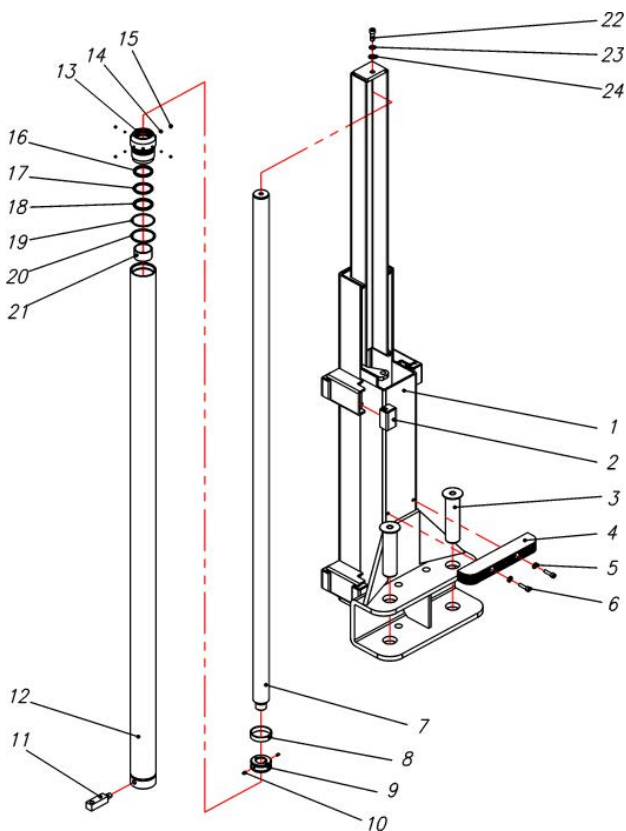

| Item | Description         | Part Number |
|------|---------------------|-------------|
| 1    | Carriage            | SB45-CA-1   |
| 2    | Carriage Guide      | SB45-CA-2   |
| 3    | Long Arm            | SB45-CA-3   |
| 4    | Long Slide Arm      | SB45-CA-4   |
| 5    | Slide Arm (3rd)     | SB45-CA-5   |
| 6    | Slide Arm (2nd)     | SB45-CA-6   |
| 7    | Short Arm           | SB45-CA-7   |
| 8    | Arm Shaft           | SB45-CA-8   |
| 9    | Large Arm Lock Gear | SB45-CA-9   |
| 10   | Small Arm Lock Gear | SB45-CA-10  |
| 11   | Arm Lock Spring     | SB45-CA-11  |
| 12   | Gear Shaft          | SB45-CA-12  |
| 13   | Spring Pin          | SB45-CA-13  |
| 14   | Wrench Bolt         | SB45-CA-14  |
| 15   | Hex Bolt            | SB45-CA-15  |
| 16   | Flat Washer         | SB45-CA-16  |
| 17   | Arm Support Rubber  | SB45-CA-17  |
| 18   | Arm Supporter       | SB45-CA-18  |
| 19   | Arm and Supporter   | SB45-CA-19  |

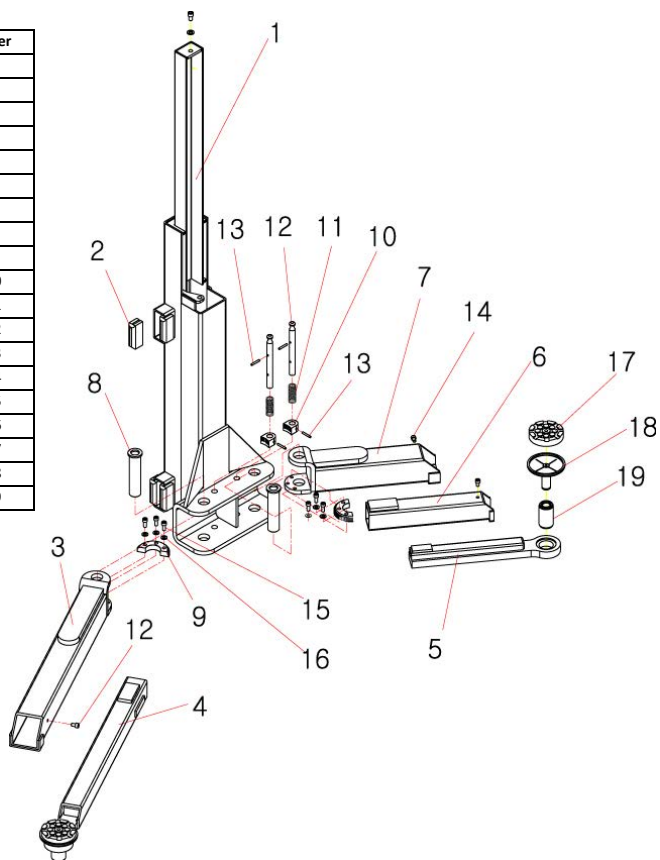

| Item | Description           | Part Number |
|------|-----------------------|-------------|
| 1    | Upper Support Beam    | SB45-CB-1   |
| 2    | Wire Roller Shaft     | SB45-CB-2   |
| 3    | Snap Ring             | SB45-CB-3   |
| 4    | Wire Roller Shaft     | SB45-CB-4   |
| 5    | Wire Roller Spacer    | SB45-CB-5   |
| 6    | Limit Switch          | SB45-CB-6   |
| 7    | E-Ring                | SB45-CB-7   |
| 8    | Limit Switch Fixture  | SB45-CB-8   |
| 9    | Upper Limit Touch Bar | SB45-CB-9   |
| 10   | Hexa Bolt             | SB45-CB-10  |
| 11   | Hexa Nut              | SB45-CB-11  |
| 12   | Flat Washer           | SB45-CB-12  |

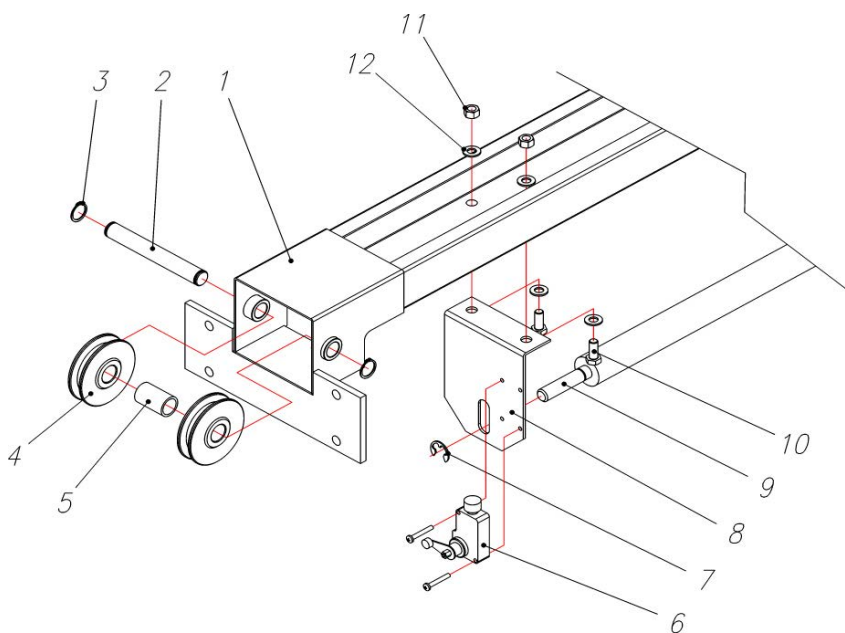

## Pressure Valve Adjustment

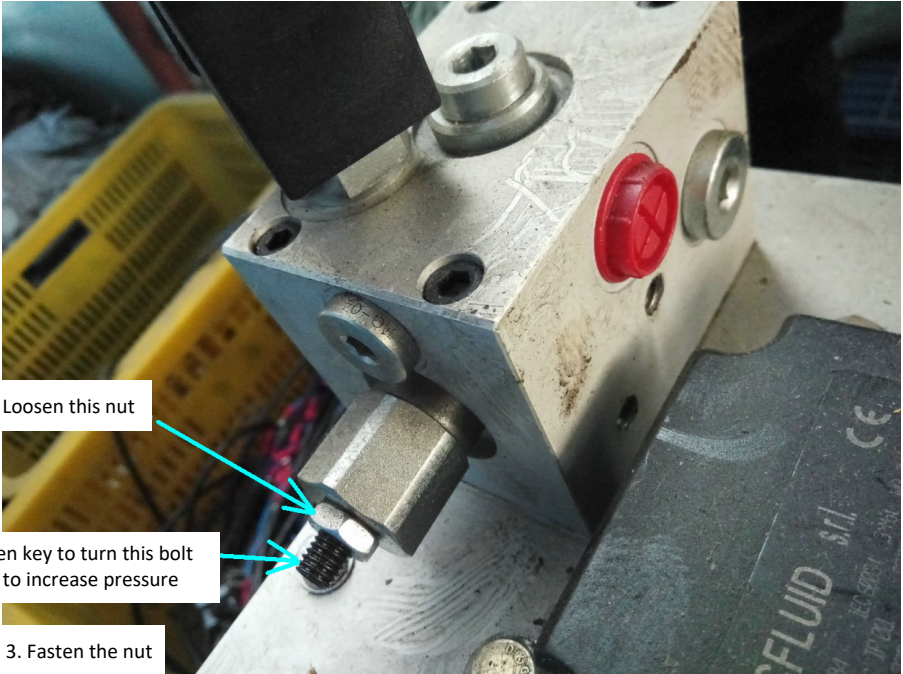

1. Loosen this nut

2. Use Allen key to turn this bolt clockwise to increase pressure

3. Fasten the nut



**MOLNAR**

PART OF THE STENHØJ GROUP

|          |                                                                          |
|----------|--------------------------------------------------------------------------|
| Address: | 3 Graham Street<br>Export Park<br>South Australia 5950                   |
| Ph:      | <b>+61 (08) 8234 3611</b>                                                |
| Fax:     | <b>+61 (08) 8234 4322</b>                                                |
| Email:   | <a href="mailto:sales@molnarhoists.com.au">sales@molnarhoists.com.au</a> |
| Web:     | <a href="http://www.molnarhoists.com.au">www.molnarhoists.com.au</a>     |