

CM255-A

TWO POST HOIST



MOLNAR
By NEXION

Technical Data	Lifting capacity	5500 kg
	Lifting height	1990 mm
	Working height	105 - 2005 mm
	Lifting / lowering time	approx. 50 seconds
	Motor unit	3.0 kW
	Voltage	400V 50Hz 16A (single phase available)
Arm Structure	Lifting pad	105– 145 mm adjustable
	Minimum height	105 mm
	Drive-through width	2898 mm
	Total width - outer edges base plates	3920 mm
	Total height including post	4050 mm
	Arm length front, minimum – maximum	915– 1850 mm
	Arm length rear, minimum – maximum	915 – 1850 mm



Posts:

- Symmetric post installation
- Very stable bent posts
- Without base frame, therefore free drive-in situation
- One power pack with low power consumption
- Carriage with optimized sliding block for low friction
- Double door-stop mounted on carriage
- Electrically operated safety ratchet system, no expensive compressed air required
- Pushbutton control unit with parking button and alarm signal
- Mechanic synchronization via steel cables
- Single post construction for easy install

Arms:

- Double telescopic front and rear arms as standard
- Automatic arm locking system
- Low minimum height
- Suitable for passenger cars up to big vans and transporters
- Pad Extensions Included

Standard Colours:

- Arms, posts and carriage: RAL 2002
- Custom colours available

Extras & Accessories

- Range of lifting pads
- Single phase
- Column Extensions 600mm and 1200mm

Service & Support

- 3 year warranty
- Spare parts stocked locally in Australia for 24 working hour dispatch

Specifications/Images subject to change without prior notice. To validate warranty, proof of a valid maintenance contract will be required. Images and Illustrations are indicative and may be modified without notice

CM255-A

Universal Full Symmetric Electro-Hydraulic Two Post Vehicle Hoist - 5.5 Tonne Capacity



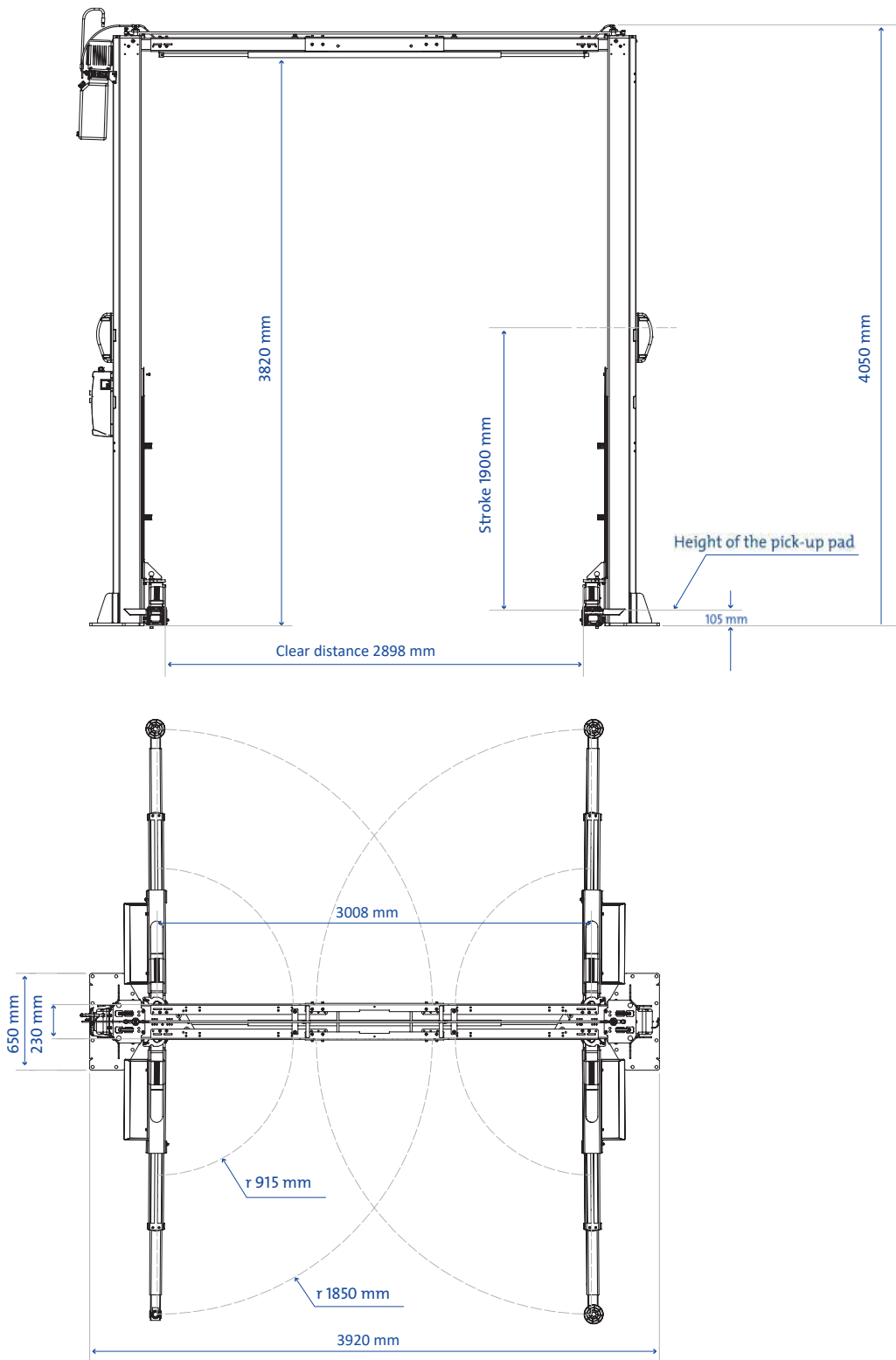

Specifications/Images subject to change without prior notice. To validate warranty, proof of a valid maintenance contract will be required. Images and Illustrations are indicative and may be modified without notice

**Lifting
the Level**

For more information,
please contact MOLNAR or your
local MOLNAR representative

www.molnarhoists.com.au

☎ 1300 MOLNAR (1300 665 627)
☎ 08 8234 3611 📠 08 8234 4322
✉ sales@molnarhoists.com.au

🌐 www.molnarhoists.com.au MolnarAustralia